

EC85TB

EC85TB designed with an advanced commercial look and appeal to include all the features and benefits of Thermeco's unique residential solutions. Offering superior thermal performance for the most demanding architectural projects no matter where the location is in Australia.

Thermally broken systems have been designed for improved energy efficiency. Our commitment to environmentally sustainable window solutions delivers you greater comfort of living and increased savings in your heating and cooling costs.

Energy Rating WERS

GLAZING	Casement		Fixed	
	U	SHGC	U	SHGC
6mm Clear Toughened / 12mm Argon / 6mm Clear Toughened	2.9	0.46	2.7	0.62
6mm Energy Tech / 12mm Argon / 6mm Clear Toughened	2.4	0.40	1.9	0.54
6mm Performa Tech / 12mm Argon / 6mm Clear Toughened	2.2	0.21	1.7	0.27
6mm Insulmax 564 / 12mm Argon / 6mm Clear Toughened	2.2	0.18	1.7	0.24
6mm Sunergy Clear / 12mm Argon / 6mm Clear Toughened	2.5	0.33	2.1	0.45
6.38mm Clear ComfortPlus / 12mm Argon / 6mm Clear Toughened	2.4	0.39	1.9	0.53
6mm LightBridge / 12mm Argon / 6mm Clear Toughened	2.4	0.37	1.9	0.50
6mm Energytech / 12mm Argon / 12mm Air / 6mm Clear	2.0	0.33	1.5	0.46

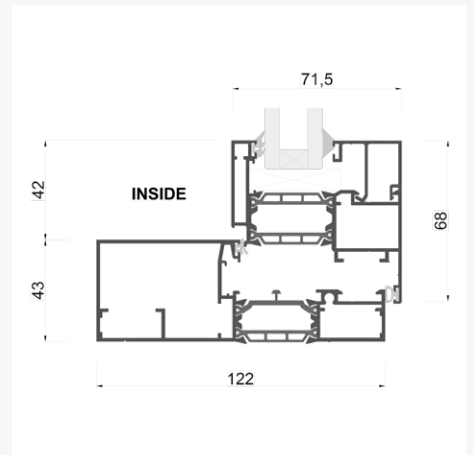

Opening Styles



FIXED



CASEMENT



AWNING



HINGED DOORS

Max Width	various	1000	1000	1000
Max Height	various	2300	2000	3000
Max Weight	various	100kg	60kg	100kg

Windows for meaningful living.

15 Kelletts Road
Rowville VIC Australia 3178
P +61 3 9763 1089
windows@thermeco.com.au
thermeco.com.au

